

# User Manual

(Plug & Play option)

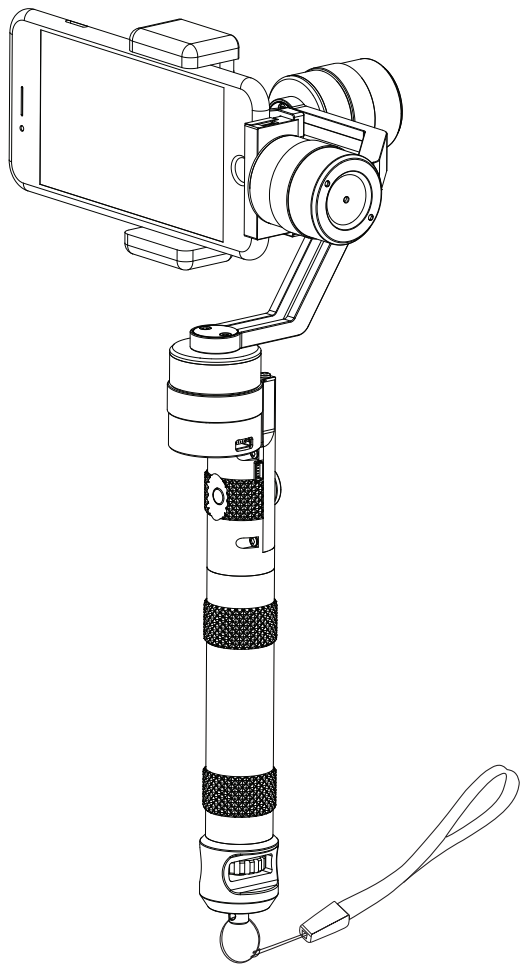

## Disclaimer and Warning

Thanks for purchasing this products. Please use the product strictly in accordance with this manual.

Please read this instruction manual carefully before using the product. By using this product, you hereby agree to this disclaimer and signify that you have read it in full.

The gimbal is calibrated well before leaving the factory. Mount the camera and battery, switch on to use.

Please do not calibrate the gimbal or change the structure without prior notice. As our factory has no control over use, setup, final assembly, modification or misuse, no liability shall be assumed nor accepted for any resulting damager or injury. By the act of use, setup or assembly, the user accepts all resulting liability. We assume no liability for damages or injuries incurred directly or indirectly from the use of this product.

Any problems while mounting or using this product, please contact with the authorised agent or the customer service of our company.

## Description

For iPhone 6s Plus / 6s / 6 Plus / 6 / 5s / 5C / 5 / 4s / 4 and same size mobile phone .



Full aluminum handle with comfortable holding feel and easy-to-use. Light weight, portable, friendly use, plug and play. Fast moving, chasing or turning, easy and flexible to shoot in ultra-low angle. Battery life time more than 4 hours.

Easy to capture the distant views with external extension rod.

## Content

Disclaimer and Warning .....	2
Description .....	2
Content .....	2
List .....	3
Phone installation .....	3
Battery installation .....	4
Appearance & Function button.....	4
External extension rod .....	5
Characteristic .....	6
Customized axis position .....	6
Care and maintenance .....	6
Common problem and solution .....	6

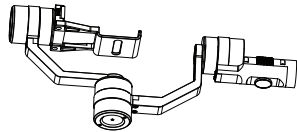
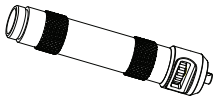
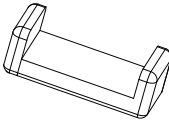
## List

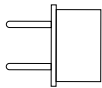
Stabilizer x1	Handle x1
	
Clip x1	R123A/16340 3.7V x4
	
Adapter X1pcs	Other
	1/4"Screw x1pcs Charger for batter 16340

## Phone installation

Please mount the clip before install the mobile phone.

1. Mount the clip as per pic 1.
2. Pull the clip and mount the mobile phone as pic 2.

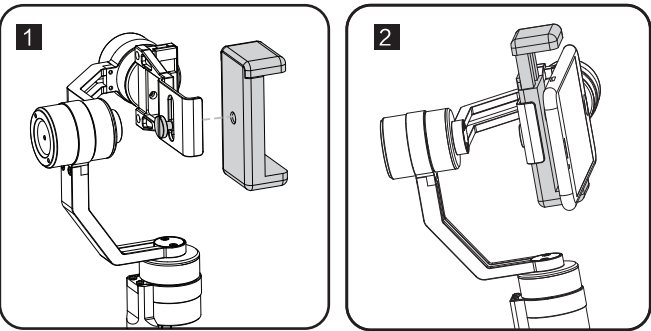

• Please remove the cover while mount the mobile phone.

Battery installation

The handle packed separately before leaving the factory, install the 3pcs battery 16340 properly as below picture and screw up.

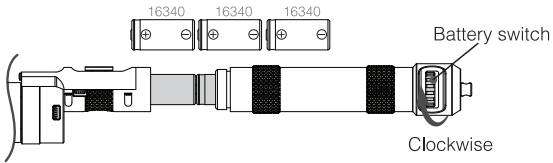

- 1. Battery switch is the gimbal switch, please ensure the switch is off while mounting.( Clockwise to switch on, counter clockwise to switch off);
- 2. Please ensure the battery installed properly.
- 3. If battery fixed not firm enough, the battery will be bad contact or failed to read.

Appearance & Function button

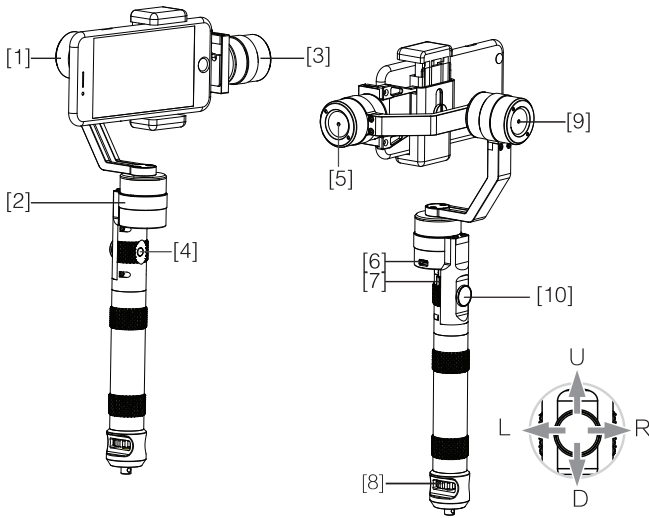

- [1]. Roll axis
- [2]. Yaw axis
- [3]. Pitch axis
- [4]. Function button

This gimba comes with 3 types working modes before leaving the factory, switch as following steps,  
1. Press 1 time, access Yaw Follow mode, sound "Da Da Di" means ok.  
2. Press 2 times, access Yaw Lock mode, sound " Da Da Di" means ok.  
3. Press 3 times, access Pitch Lock, Yaw Follow mode, sound "Da Da Di" means ok.

5. Signal light  
The gimbal works with light on.

6. USB port  
For calibration and upgrade.

7. External joystick port  
The control signal will be transferred to the external joystick via this port to switch working modes and control the gimbal.

8. Power switch  
Power switch is battery switch as well as gimbal switch, mount the battery and turn clockwise to start.

9. Power indicator light  
Indicator light will be green when fully charged; Low battery warning will appear when turned yellow; It is time to charge the battery when the indicator light turned red and keep blinking.

10. Camera movement button  
Four directions can be slided, up, down, left and right. The mobile phone movement follow with the sliding direction.

External extension rod (excluded)

Connection:  
Screw out 1/4 screw from battery cap, use the extension rod with 1/4 external thread instead to capture the distant views easily.  
Extension rod:  
Our 1.5m handheld extension rob or the other extension rods with 1/4 thread.

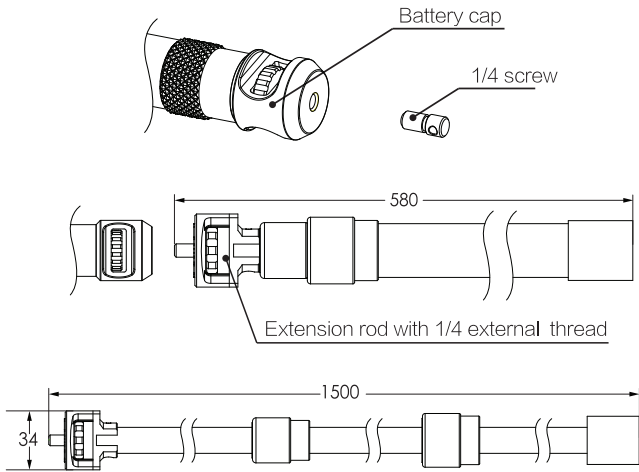

Characteristic

Item	Min	Std	Max	Comment
Operating voltage	7.4V	11.1V	12.6V	
Operating current	60mAh	80mAh	2.5A	
Static tracking accuracy	±0.01°		±0.04°	
Dynamic tracking accuracy	±0.1°	±0.2°	±0.04°	
Pitch range	-180°	0°	+120°	
Roll range	- 45°	0°	+45°	
Yaw range	- 150°	0°	+150°	Vertical handheld
Yaw range	- 50°	0°	+50°	Horizontal handheld
Pitch follow speed	1°/S		50°/S	
Yaw follow speed	1°/S		80°/S	
Battery life time (25 C )	1.5H	5H	6H	650mAh x3
Working temperature	- 20°	25°	45°	
Weight		416g		Without battery and phone

● Note: Please do not use stabilizer exceed the above angles, otherwise the stabilizer will work improperly.

※ Customized axis position

Setting method:  
User turn the axis to any position while power on and stay on the place for 3 seconds, the gimbal will record it as home position.

Care and maintenance

Please keep sand proof, dust proof and water proof while using. Please clean the gimbal with soft dry cloth when available.

Common problem and solution

1. How to do for the drift issue?  
Solution: It may caused by the temperature or the error of magnet effect.